



D Series Vertical Seal-Less Immersible Pumps

1/8 HP

KEY FEATURES

- CPVC, Natural PP and PVDF
- No Seals to Leak or Replace
- PTFE Fume Barrier
- FPM Elastomer
- Optional Inlet Screens

OPTIONS

- In-Tank Filtration
- Inlet Screens
- EPDM Elastomer
- Impeller Trim Variations
- Explosion Proof Motors
- Washdown Motors
- 575V Motors
- S-J Type Electrical Cord

MATERIALS

- CPVC Cell Class 23447 per ASTM D1784
- PP per ASTM D4101
- GFPP Cell Class 85580 per ASTM D4101
- PVDF

TECHNICAL INFORMATION

SPECIFICATIONS

PUMP HEAD	CPVC, PP or PVDF Construction
PIPE CONNECTION	Threaded Connections
SHAFT	Stainless Steel Shaft with Non-Metallic Sleeve
SEAL	PTFE Fume Barrier Protects Motor and Bearings, FPM O-Rings
PERFORMANCE	Flow Rates from 2 to 17 GPM with TDHs up to 18 Feet
MOTORS	Single Phase Motor with 1/8 HP, 115/230 VAC has Heavy Duty TEFC, Epoxy Painted Construction and is Rated for Continuous Duty Service. The Motor Features a 1/2" Diameter Extended Stainless Steel Shaft and Sealed Ball Bearings with "Slinger" Lip Seal.
PUMP MODELS	1/8 HP

D Series Vertical Seal-Less Immersible Pumps

1/8 HP

TECHNICAL INFORMATION, *CONTINUED*

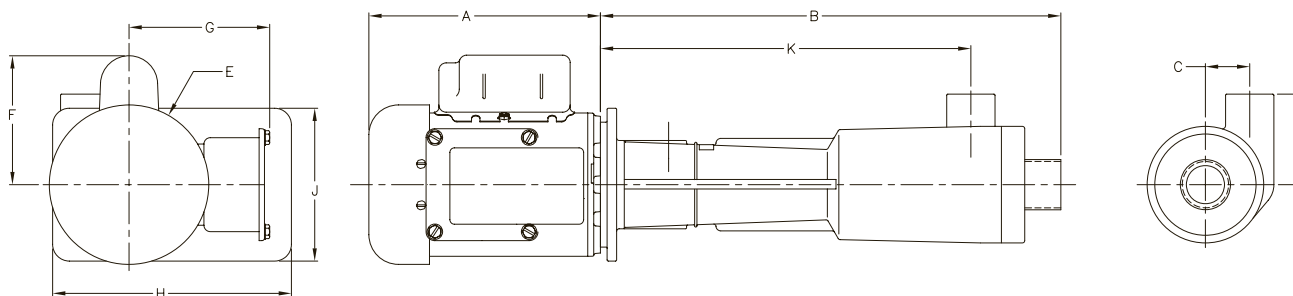

DIMENSIONS

	A in/mm	B in/mm	C in/mm	D in/mm	E in/mm	F in/mm	G in/mm	H in/mm	J in/mm	K in/mm	INLET	DISCHARGE
D1	6.06/154	12.05/306	1.16/29	2.37/60	4.17/106	3.37/86	3.68/93	6.25/159	4.00/102	9.67/246	1" MNPT	1/2" FNPT
DD1	6.06/154	12.05/306	1.16/29	2.37/60	4.17/106	3.37/86	3.68/93	6.25/159	4.00/102	9.67/246	1" MNPT	1/2" FNPT

Dimensions are subject to change without notice – consult factory for installation information

PERFORMANCE CURVES

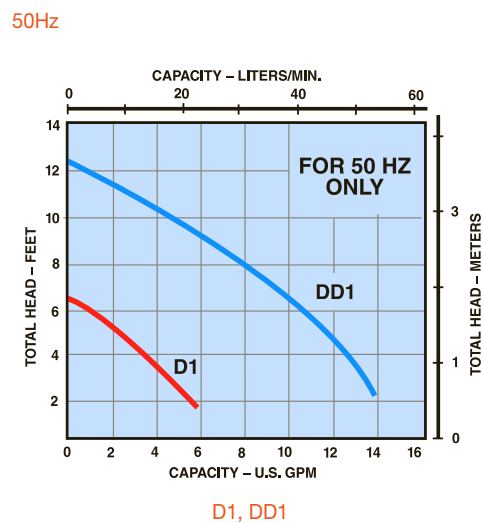
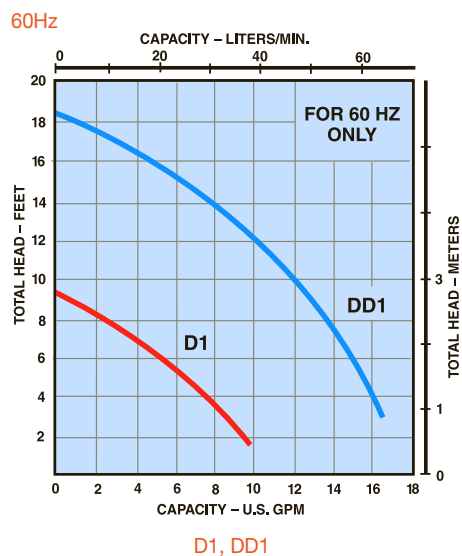

COMMERCIAL
INDUSTRIAL SUPPLY

For pricing and information please call
Commercial Filtration Supply at (866) 777-8001

Visit us Online at: www.commercial-industrial-supply.com for
more high quality process equipment.